

The Alloy Block, Downtown

The Alloy Block, Downtown is five buildings, old and new, that provide residential, educational, office, cultural, and retail spaces for the people of Downtown Brooklyn.

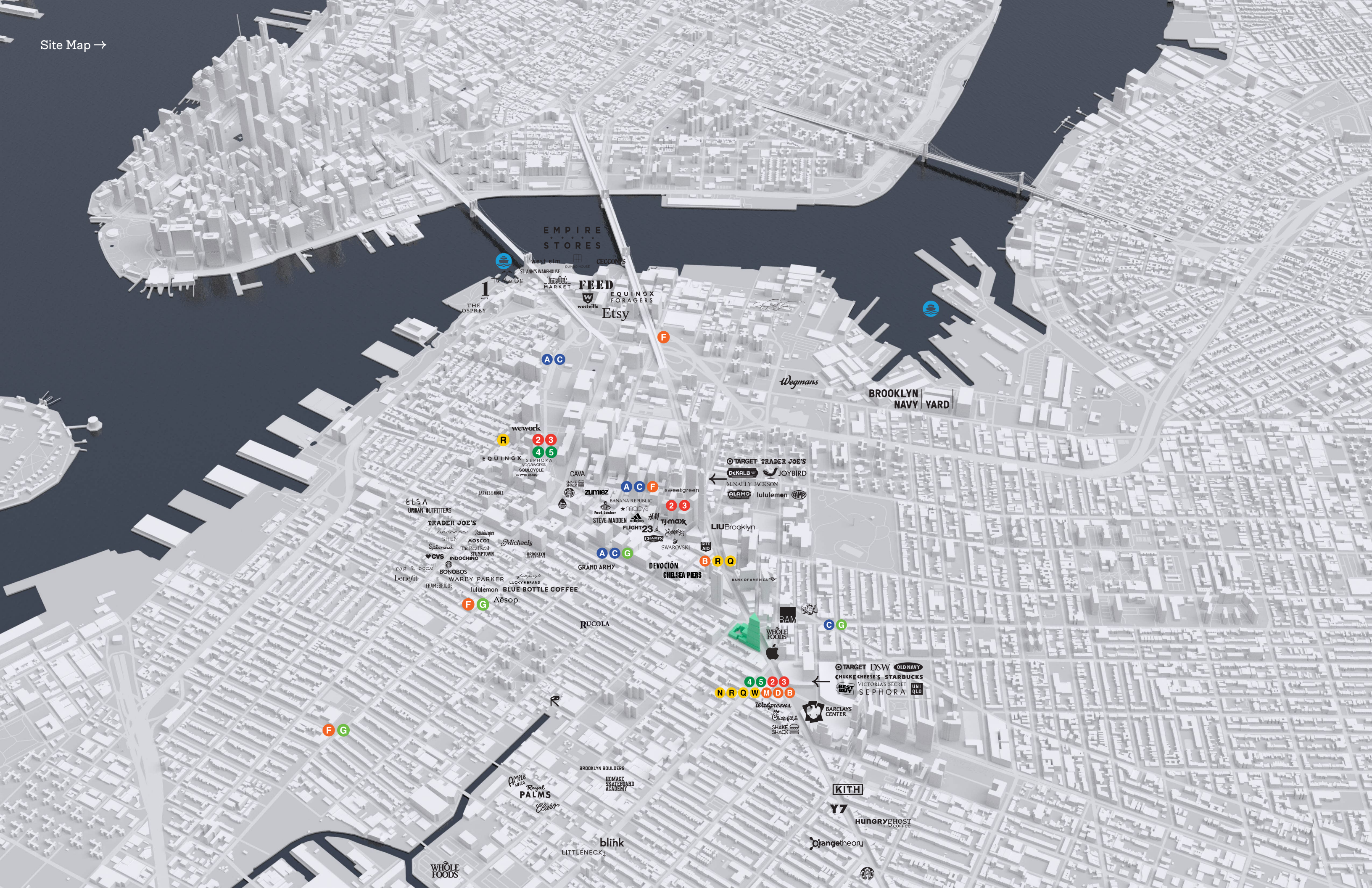

EMPIRE STORES

1 THE OSPREY

west elm

CECCONI'S

ST ANN'S WARHOUSE

Time Out MARKET

FEED

EQUINOX FORAGERS

Etsy

F

A C

Wegmans

BROOKLYN NAVY YARD

wework

R

2 3

4 5

EQUINOX

SEPHORA

SOULCYCLE

WITOLDSON'S

CAVA

SHAKE SHACK

ZUMIEZ

BANANA REPUBLIC

Foot Locker

STEVE MADDEN

FLIGHT 23

CHAMPS

GRAND ARMY

DEVOCIÓN

CHELSEA PIERS

RUCOLA

WALGREENS

WHOLE FOODS

APPLE

LIU Brooklyn

LIU Brooklyn

LIU Brooklyn

LIU Brooklyn

LIU Brooklyn

LIU Brooklyn

LIU Brooklyn

LIU Brooklyn

LIU Brooklyn

LIU Brooklyn

LIU Brooklyn

LIU Brooklyn

LIU Brooklyn

LIU Brooklyn

LIU Brooklyn

LIU Brooklyn

LIU Brooklyn

TARGET TRADER JOE'S

DEKALB JOYBIRD

M.NALLY JACKSON

ALAMO lululemon

ALAMO lululemon

ALAMO lululemon

ALAMO lululemon

ALAMO lululemon

ALAMO lululemon

ALAMO lululemon

ALAMO lululemon

ALAMO lululemon

ALAMO lululemon

ALAMO lululemon

ALAMO lululemon

ALAMO lululemon

ALAMO lululemon

ALAMO lululemon

ALAMO lululemon

ALAMO lululemon

ALAMO lululemon

ALAMO lululemon

ALAMO lululemon

ALAMO lululemon

ALAMO lululemon

ALAMO lululemon

ALAMO lululemon

ALAMO lululemon

ALAMO lululemon

ALAMO lululemon

ALAMO lululemon

ALAMO lululemon

ALAMO lululemon

ELSA

URBAN OUTFITTERS

TRADER JOE'S

SHEN

MOSCOT

Splendid

The Real Real

STUMPTOWN

CVS INDOCHINO

rag & bone

BONOBOS

WARBY PARKER

FRAMEBRIDGE

benefit

benefit

benefit

benefit

benefit

benefit

benefit

benefit

benefit

benefit

benefit

benefit

benefit

benefit

benefit

benefit

benefit

F G

F G

F G

F G

F G

F G

F G

F G

F G

F G

F G

F G

F G

F G

F G

F G

F G

F G

F G

F G

F G

F G

4 5 2 3

N R Q W M D B

N R Q W M D B

N R Q W M D B

N R Q W M D B

N R Q W M D B

N R Q W M D B

N R Q W M D B

N R Q W M D B

N R Q W M D B

N R Q W M D B

N R Q W M D B

N R Q W M D B

N R Q W M D B

N R Q W M D B

N R Q W M D B

TARGET DSW OLD NAVY

CHUCKE CHEESE'S STARBUCKS

VICTORIA'S SECRET

SEPHORA

SEPHORA

SEPHORA

SEPHORA

SEPHORA

SEPHORA

SEPHORA

SEPHORA

SEPHORA

SEPHORA

SEPHORA

SEPHORA

SEPHORA

SEPHORA

BEST BUY

BEST BUY

BEST BUY

BEST BUY

BEST BUY

BEST BUY

BEST BUY

BEST BUY

BEST BUY

BEST BUY

BEST BUY

BEST BUY

BEST BUY

BEST BUY

BEST BUY

BEST BUY

BEST BUY

WALGREENS

WALGREENS

WALGREENS

WALGREENS

WALGREENS

WALGREENS

WALGREENS

WALGREENS

WALGREENS

WALGREENS

WALGREENS

WALGREENS

WALGREENS

WALGREENS

WALGREENS

WALGREENS

WALGREENS

SHAKE SHACK

SHAKE SHACK

SHAKE SHACK

SHAKE SHACK

SHAKE SHACK

SHAKE SHACK

SHAKE SHACK

SHAKE SHACK

SHAKE SHACK

SHAKE SHACK

SHAKE SHACK

SHAKE SHACK

SHAKE SHACK

SHAKE SHACK

SHAKE SHACK

SHAKE SHACK

SHAKE SHACK

BARCLAYS CENTER

BARCLAYS CENTER

BARCLAYS CENTER

BARCLAYS CENTER

BARCLAYS CENTER

BARCLAYS CENTER

BARCLAYS CENTER

BARCLAYS CENTER

BARCLAYS CENTER

BARCLAYS CENTER

BARCLAYS CENTER

BARCLAYS CENTER

BARCLAYS CENTER

BARCLAYS CENTER

BARCLAYS CENTER

BARCLAYS CENTER

BARCLAYS CENTER

KITH

KITH

KITH

KITH

KITH

KITH

KITH

KITH

KITH

KITH

KITH

KITH

KITH

KITH

KITH

KITH

KITH

Y7

Y7

Y7

Y7

Y7

Y7

Y7

Y7

Y7

Y7

Y7

Y7

Y7

Y7

Y7

Y7

Y7

HUNGRY GHOST

HUNGRY GHOST

HUNGRY GHOST

HUNGRY GHOST

HUNGRY GHOST

HUNGRY GHOST

HUNGRY GHOST

HUNGRY GHOST

HUNGRY GHOST

HUNGRY GHOST

HUNGRY GHOST

HUNGRY GHOST

HUNGRY GHOST

HUNGRY GHOST

HUNGRY GHOST

HUNGRY GHOST

HUNGRY GHOST

ORANGETHEORY

ORANGETHEORY

ORANGETHEORY

ORANGETHEORY

ORANGETHEORY

ORANGETHEORY

ORANGETHEORY

ORANGETHEORY

ORANGETHEORY

ORANGETHEORY

ORANGETHEORY

ORANGETHEORY

ORANGETHEORY

ORANGETHEORY

ORANGETHEORY

ORANGETHEORY

ORANGETHEORY

BLINK

BLINK

BLINK

BLINK

BLINK

BLINK

BLINK

BLINK

BLINK

BLINK

BLINK

BLINK

BLINK

BLINK

BLINK

BLINK

BLINK

LITTLE NECK

LITTLE NECK

LITTLE NECK

LITTLE NECK

LITTLE NECK

LITTLE NECK

LITTLE NECK

LITTLE NECK

LITTLE NECK

LITTLE NECK

LITTLE NECK

LITTLE NECK

Aerial →
The project is located on Flatbush Avenue, directly across from Atlantic Terminal in Downtown Brooklyn.

← 20 minutes to One World Trade

100 Flatbush at
The Alloy Block,
Downtown

28,000 SF of Retail
440 Residential Units

← One Hanson Place

← Apple DTBK

← Atlantic Terminal

Barclays Center, Home to the Brooklyn Nets →



The Alloy Block, Downtown has a total of 28,000 SQF of retail space available, with 433' LF of frontage on Flatbush Avenue, State Street, and Temple Square.

Downtown Brooklyn →
The first tower will be 484' tall
with views of Manhattan and
greater Brooklyn.



KGIA and the new
lower school will be
the city's first passive
house public schools.

100 Flatbush is the
city's first all-electric
skyscraper.

Retail Opportunity →
The base of the tower houses
multiple retail spaces directly
across from the Apple Store on
Flatbush Avenue.



Retail Space A →

← Apple DTBK

Atlantic Terminal →

Retail Spaces, 100 Flatbush

Ground Level

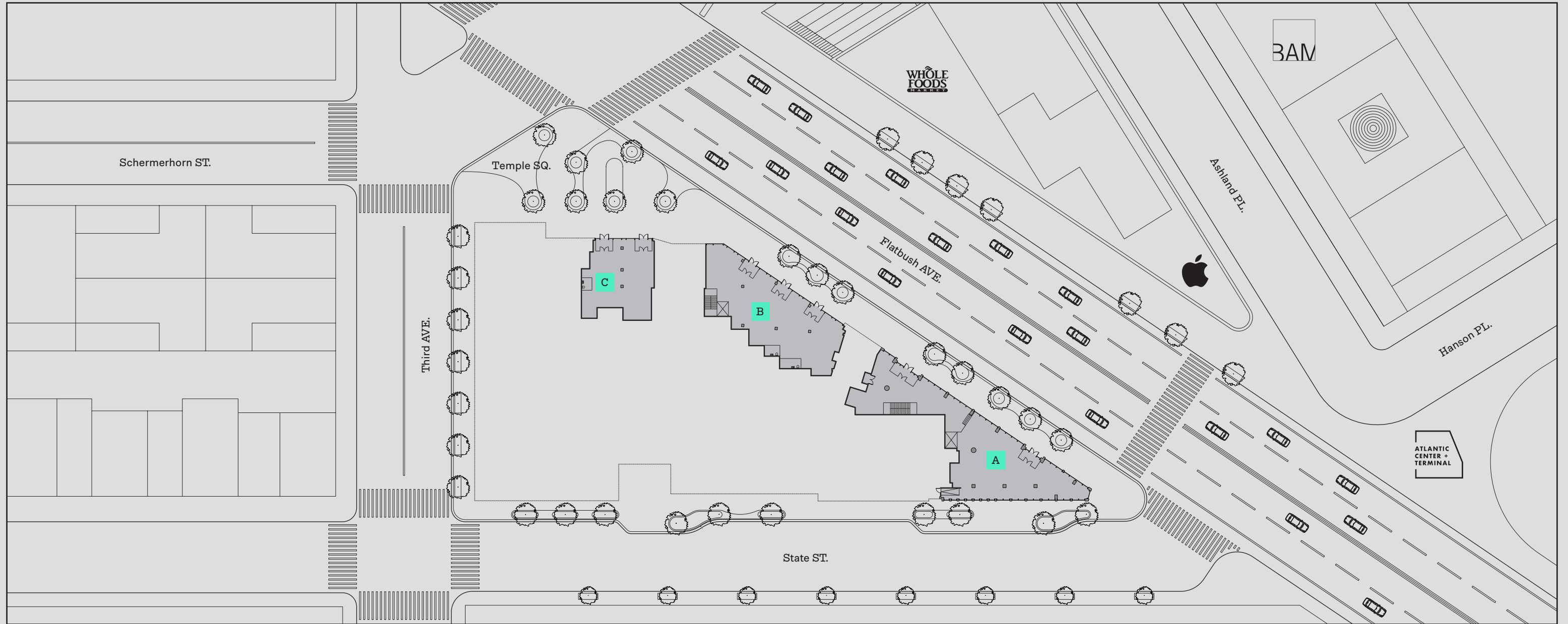

0' 40' 80' 160'



The Alloy Block,
Downtown

A → 6,467 SQF
B → 5,104 SQF
C → 2,731 SQF

Lower Level

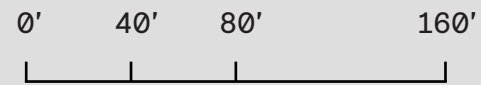

The Alloy Block,
Downtown

A → 6,746 SQF
B → 7,554 SQF

A. 6,467^{SQF} → Ground Level

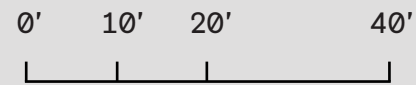
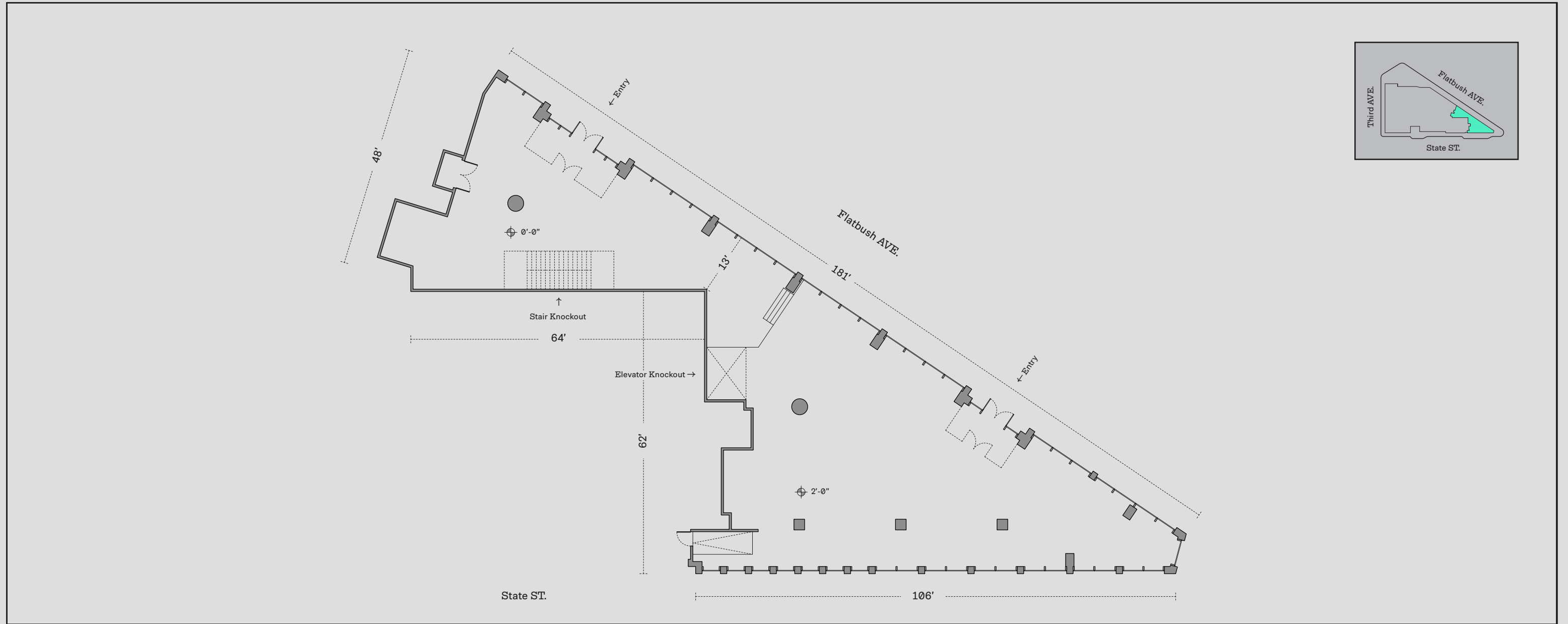

The Alloy Block,
Downtown

Ceiling Height → 21'-3"
Flatbush Avenue Frontage → 181'
State Street Frontage → 106'

A. 6,746^{SQF} → Lower Level

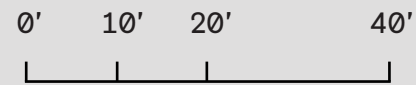
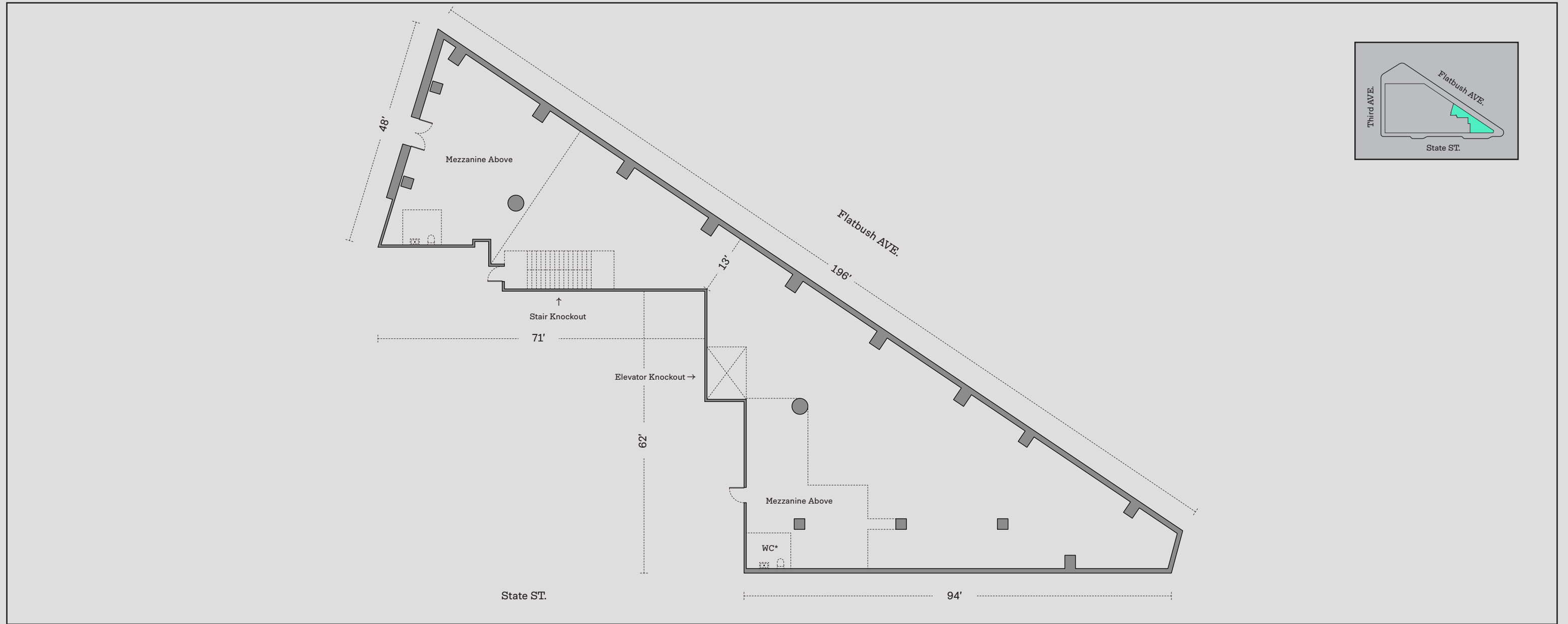

B. 5,104^{SQF} → Ground Level

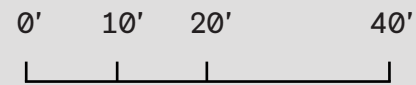
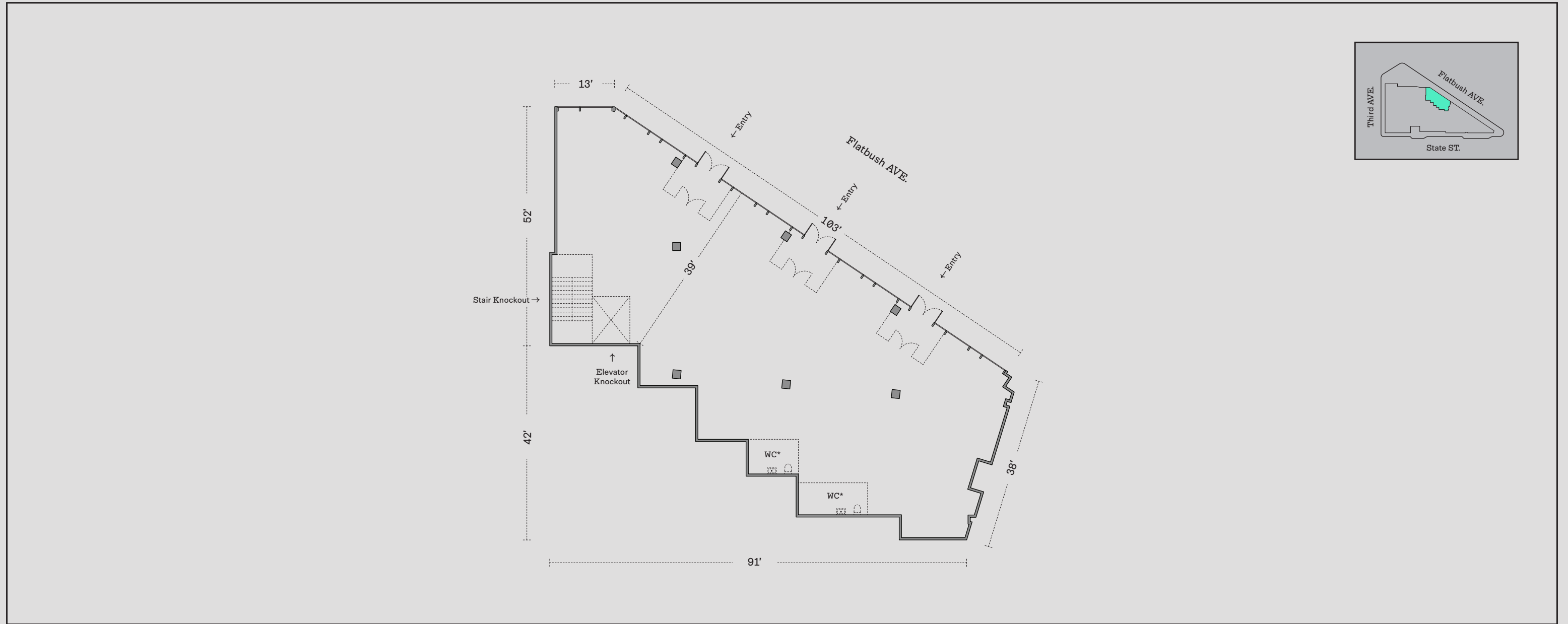

The Alloy Block,
Downtown

Ceiling Height → 22'-9"
Flatbush Avenue Frontage → 103'
Temple Square Frontage → 13'
WC* → Tenant Provided

B. 7,554^{SQF} → Lower Level

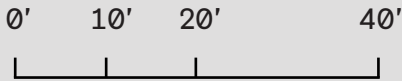
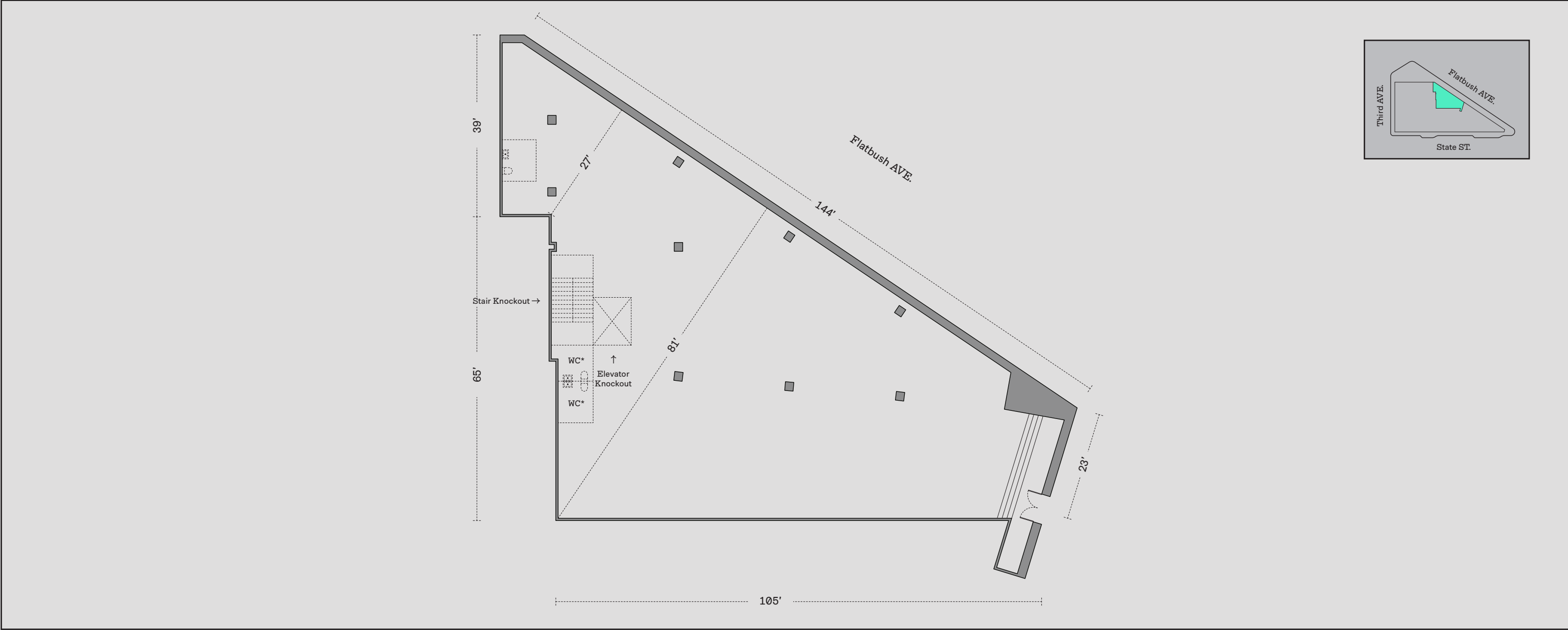

C. 2,731 SQF → Ground Level

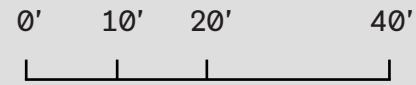
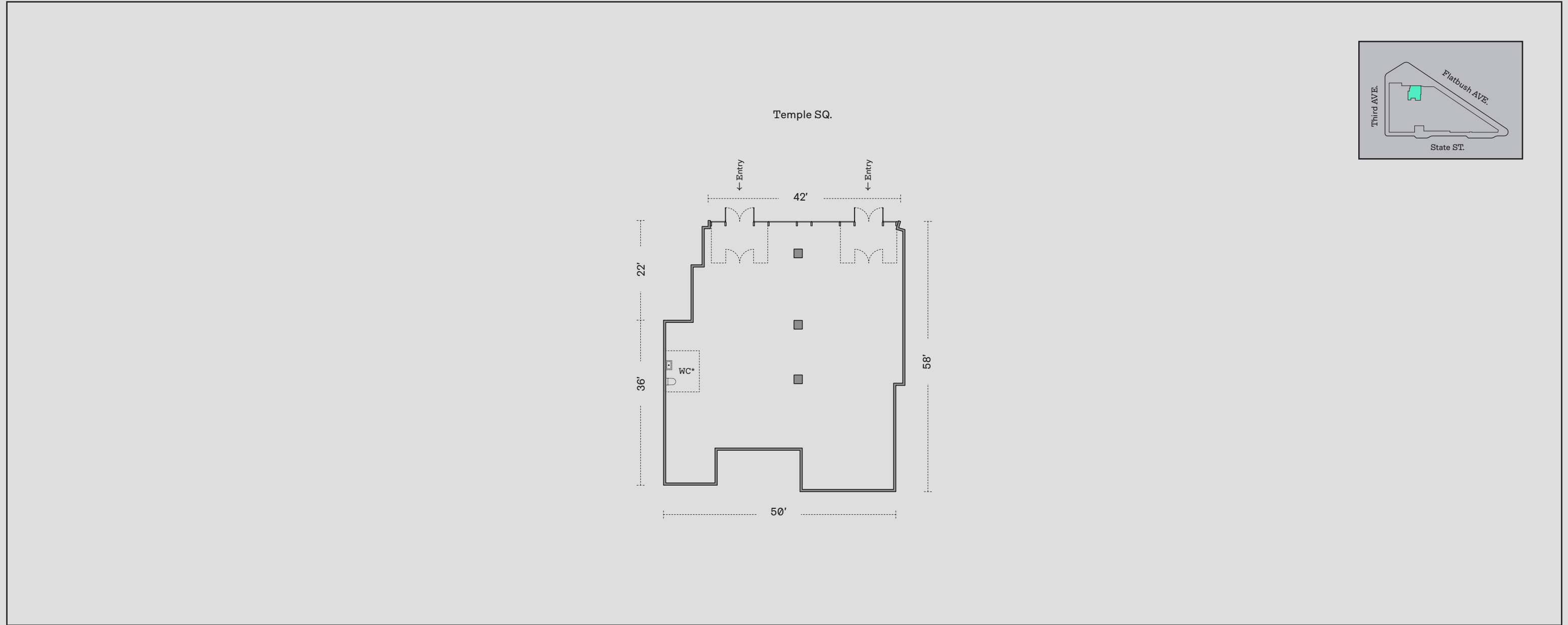

Crossing The Street →
A new cross-walk will be
installed, linking the prow of
100 Flatbush to the Apple Store
across Flatbush Avenue.



Retail Space A →

← Retail Space B

A → Ground Level
Retail Space A is 6,467 SQF
with 17'-3" ceiling heights, with
frontage on Flatbush Avenue and
State Street.



B → Ground Level
Retail Space B is 5,104 SQF with
22' ceiling heights, with frontage
on Flatbush Avenue.



C → Ground Level
Retail Space C is 2,731 SQF with
22' ceiling heights, with frontage
on Temple Square.



Location →
The Alloy Block, Downtown
will front Flatbush Avenue with
multiple cross-walks linking to
the BAM cultural district.



Retail Space A →

Retail Space B

← Retail Space C

Alloy

Mission

At Alloy, we are committed to making Brooklyn beautiful, sustainable, and equitable.

Progress →
Construction has begun at 100
Flatbush and is expected to be
complete by 2024.



Contact

For more information about the retail spaces available at the *The Alloy Block, Downtown*, please contact GoodSpace.

Chris DeCrosta
cd@goodspace.nyc

Hank O'Donnell
ho@goodspace.nyc

Roberto Rhett
rr@goodspace.nyc